

# Kronos

Peristaltic dosing pump



# The **Kronos**

## PERISTALTIC METERING PUMP DRIVE BY A STEPPER MOTOR

The feed chemical is conveyed by means of the rotor squeezing on the hose. No valves are needed for this. This ensures gentle handling of the metered media.

The housing is made from shock-proof and chemical resistant PPE with IP65 protection degree. It is equipped with several inputs for metering configuration.

**The stepper motor means that metering is infinitely adjustable.**

Typical applications are in processes where only a low discharge pressure is required, such as in the metering of chemicals into galvanic baths, in clarification tanks or for metering conditioning agents into swimming pools (flocculants, activated carbon and chemicals).



## Features

### ■ DOSING

- By stepper motor technology
- Safely **up to 10 l/h** and **up to 3 bar**
- Suitable firmware micro dosing
- Minimum dosing note 2 ml/h continuous

### ■ MOTORS

- Accurate, reliable and ultra quiet <35 db
- Direct coupling

### ■ TUBING

The perfect choice to dose degassing liquid without the needs of "special" accessories

### ■ MODE

#### ● FULL MODE

**kronos** FM pump has multi-function setting there are six (6) different configuration, as following:

- Manual Mode (Constant dosing)
- mA Mode (Proportional dosing)
- PPM Mode (Concentration dosing)
- 1:N Mode (Speed up dosing)
- N:1 Mode (Speed down dosing)
- Batch Mode (Setting dosing)

#### ● CONDUCTIVITY MODE

**kronos** CR pump has a conductivity measure integrated. The dosing pump has two (2) different configuration, as following:

- Manual Mode (Constant dosing)
- Conductivity Mode (SetPoint Dosing)

## Products Line

Model	Nominal Pressure	Delivery Rate	Minimum Delivery Rate	Tubing	Tubing internal diameter
<b>kronos50</b> FM10	2 bar	10 l/h	10 ml/h	<b>seko</b> Med	6 mm
<b>kronos50</b> FM02	3 bar	2 l/h	2 ml/h	<b>seko</b> Extra	3 mm
<b>kronos50</b> CR10	2 bar	10 l/h	10 ml/h	<b>seko</b> Med	6 mm

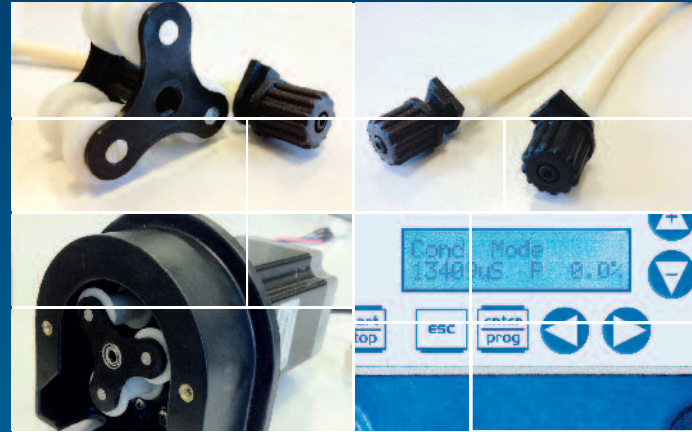

## Design and Functional description

The device is housed in a robust plastic housing.

The plastic housing is comprised of upper and lower sections, which are screwed together. The lower section contains the PCBs for power supply and connectors.

This construction technology simplify the installation: block part will easily fixed at the wall and all wire are connected on that part.

Once wiring is completed the front part can do screwed on the block one.

The liquid end is mounted at the front and is closed off by means of a screwed transparent cover to protect against injuries. The pump hose can easily be exchanged after the transparent cover has been removed.

The rotary movement of the rotors alternately press and relax pump hose by three rollers. As a result, the liquid is sucked in and transported through the pressure hose without stress. The pump si self priming in all conditions.

## Dimensions

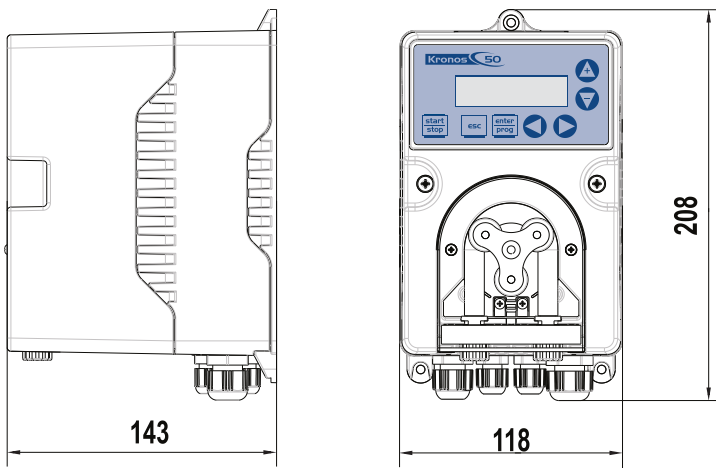

## Ordering information

Code	Model	Description
<b>KRFM0210</b>	<b>kronos50</b> FM10	kronos 10 l/h @2 bar full mode
<b>KRFM0302</b>	<b>kronos50</b> FM02	kronos 2 l/h @3 bar full mode
<b>KRCR0210</b>	<b>kronos50</b> CR10	kronos 10 l/h @2 bar conductivity mode

## A Worldwide Group at your service

**seko** is an International Group, developing, manufacturing and delivering its products in more than 50 countries, through its subsidiaries and an extended network of distributors, agents and authorized dealers.

**seko** is a leading manufacturer of dosing pumps and dosing systems with more than 40 years experience. This long activity allowed **seko** to acquire a vast experience in diversified applications and to confirm its international success in many industrial fields through the supply of reliable solutions for the dosing, injection and transfer of liquids.



**ERTEK**  
www.ertek.com

**Ertek Yapı ve Makina Endüstri Ekipmanları  
San. ve Tic. Ltd. Şti.**

Halkapınar Mah. Pamuk Plaza İş Merkezi 1082  
Sokak No: 3 M 35170 Yenışehir Konak / İZMİR  
Tel: (0232) 469 43 53 Faks: (0232) 457 46 51  
www.ertek.com • info@ertek.com

For more information



www.ertek.com