

SIDE CHANNEL BLOWERS

BL 620 002 – Double Impeller – Three Phase



Construction of the ring blowers fans is based on the lateral ducts principle. The blowers can operate as either exhaust or compression fans and are designed for continuous service. The device is assembled directly on the motor shaft; all the rotating parts are dynamically balanced to ensure absolute absence of vibration. Full die-cast aluminum construction for maximum sturdiness and ease of handling. The characteristics data given here refer to the handling of gas with inlet temperature of 15°C, normal density of 1,23 kg/m³ and absolute pressure of 1023 mbar. Tolerance of ±10%.

Model	Freq. [Hz]	Power [kW]	Voltage [V]		Rated Current [A]		Max Airflow [m ³ /h]	Rated VACUUM [mbar]	Rated COMPRESSOR [mbar]	Noise [dB A]	Weight [kg]
			△	Y	△	Y					
BL62000204000	50	4	345÷415	600÷720	9.0	5.2	320	-355	375	73	53
	60	4.6	380÷480	660÷720	9.4		385	-345	315	76	
BL62000205500	50	5.5	345÷415	600÷720	13.3	7.7	320	-440	500	73	70
	60	6.3	380÷480	660÷720			380			76	
BL62000207500	50	7.5	345÷415	600÷720	16.7	9.6	320	440	570	73	74
	60	8.6	380÷480	660÷720	17.3	10.0	380	460	660	76	

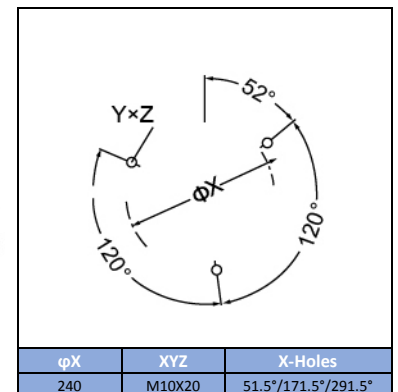
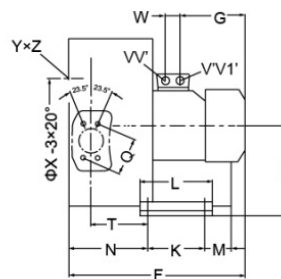
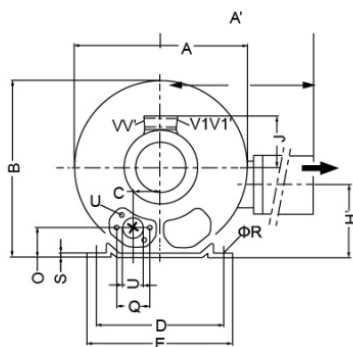
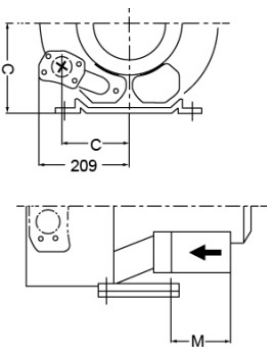
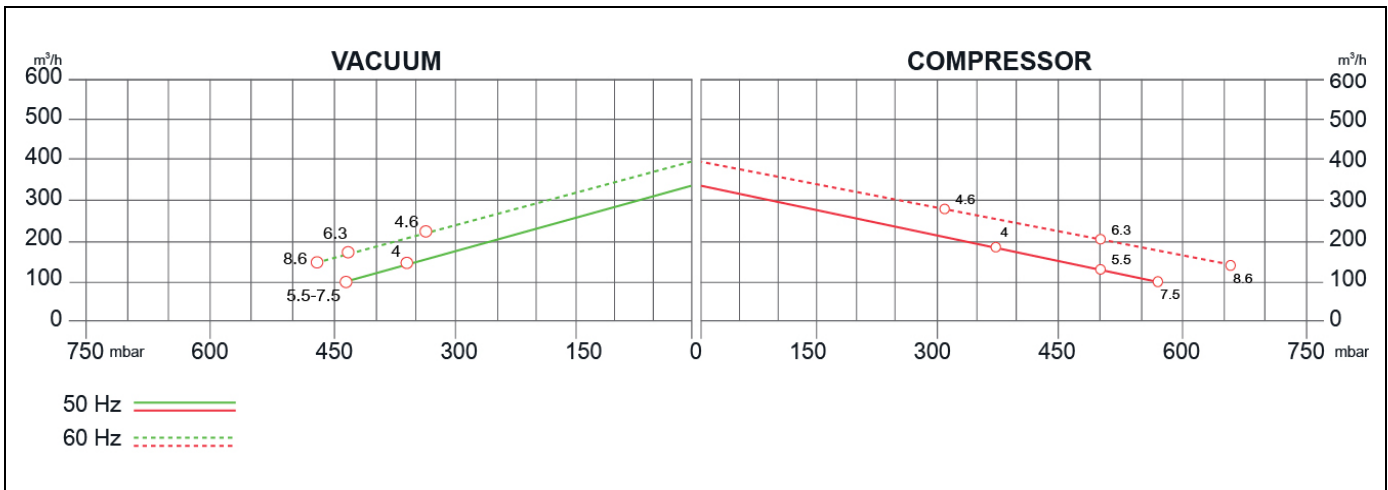

MODEL	A	A'	Bvv	C	D	E	F	G	H	H'	J	K	L	M	N	O	ØP	Q	ØR	S	T	U	V	V'	V1	V1'	W
BL62000204000	426	426	410	154	290	325			197	162		140	180		205	53	55	83	15	4.5	130	M8X17	M32X1.5	M32X1.5	M32X1.5	M32X1.5	42
BL62000205500	426	426	410	154	290	325	571	226	197	162	167	140	180	200	205	53	55	83	15	4.5	130	M8X17	M32X1.5	M32X1.5	M32X1.5	M32X1.5	42
BL62000207500	426	426	410	154	290	325	571	226	197	162	167	140	180	200	205	53	55	83	15	4.5	130	M8X17	M32X1.5	M32X1.5	M32X1.5	M32X1.5	42

Your Choice,
Our Commitment

Technical data can be changed without notice.

TD_BL620002_rev 1.0

