



## GEMAS 400 W / 230-12 V TRANSFORMERS TECHNICAL DATA SHEET



*“Pool Technology”*

Housing made of heat resistant plastic. Gasket sealed lid. Input with glass fuse, outlet with special connection terminal. Complete with hardware necessary for fixing on the wall. Winding is completely sealed.

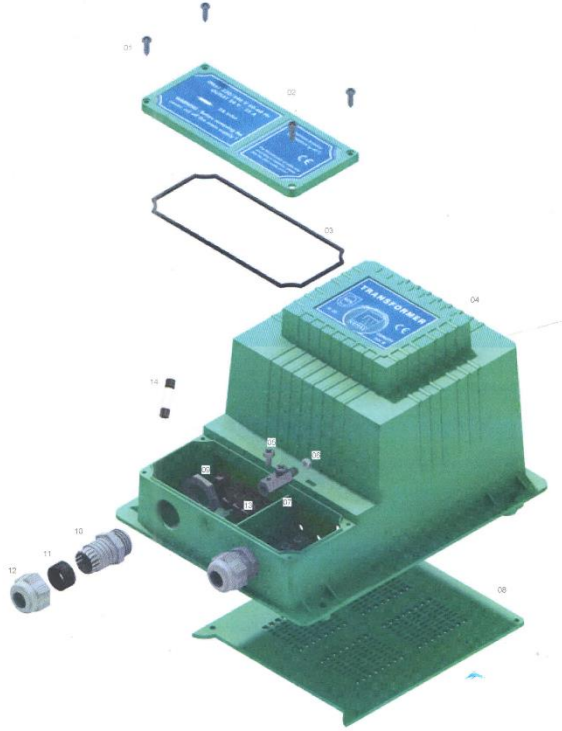

No	Description	Qty
01	Screw for top lid 4x12	4
02	Transformer front lid	1
03	Transformer front lid gasket	1
04	Transformer body	1
05	12 V Outlet connector screw	4
06	12 V Outlet connector nut	2
07	12 V Outlet chrome – plated	2
08	Transformer bottom lid	1
09	Grey union nut PG16	2
10	Grey – plastic union body PG16	2
11	Grey union joint PG16	2
12	Grey – plastic union screw	2
13	Cable connection (3 way)	1
14	Glass fuse 3A	1

### VOLTAGE DROP CHART IN VOLTS FOR 400W/12V TRANSFORMERS

		CABLE DISTANCE FROM TRANSFORMER TO UW LIGHT								
		9	12	15	18	21	24	27	30	51
CABLE TYPE	2x4	-1,5V	-2V	-3V	-	-	-	-	-	-
	2x6	-	-1,5V	-1,7V	-2V	-2,5V	-2,7V	-3,1V	-3,5V	-5,2V

