

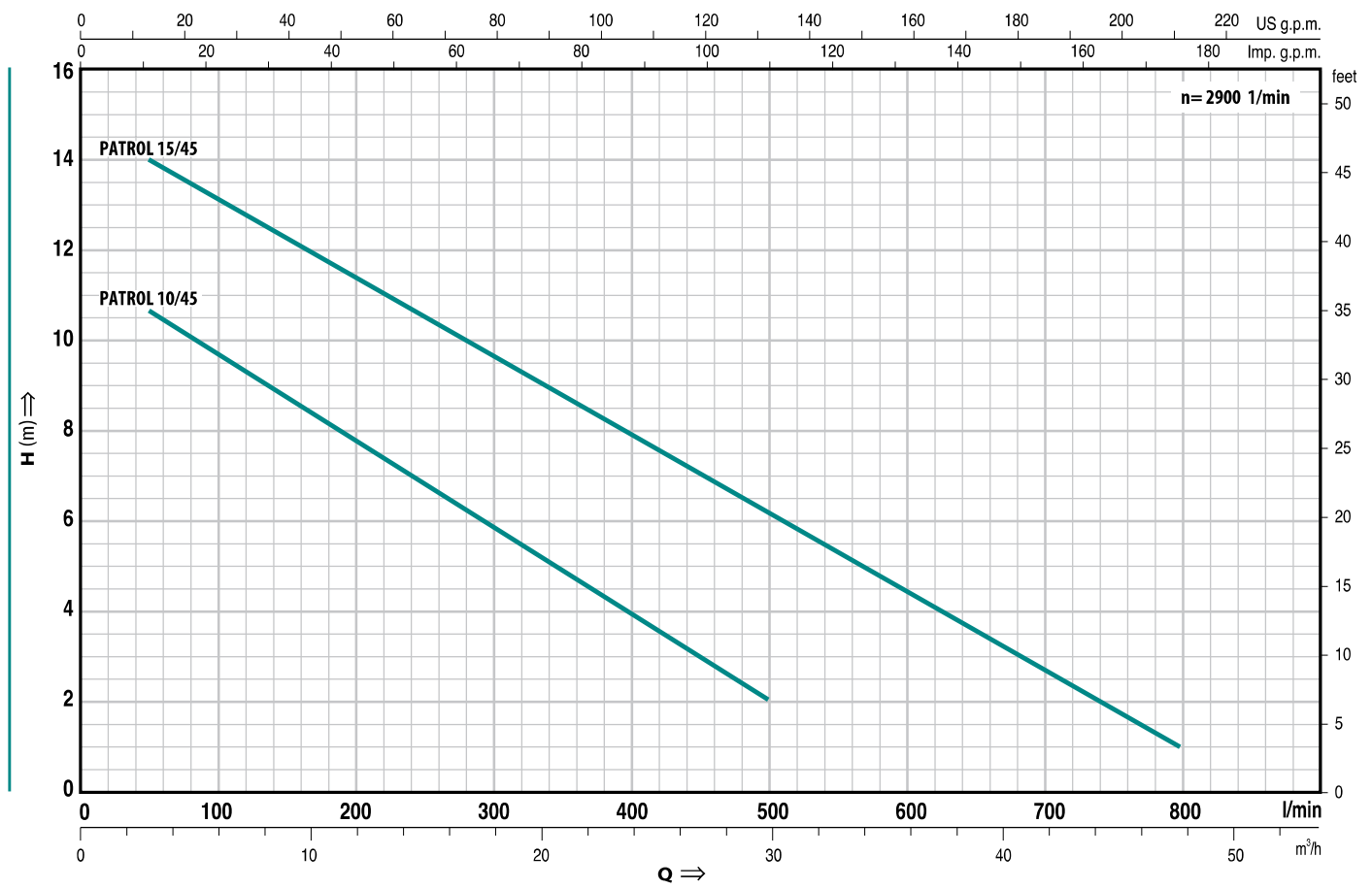

PATROL 45

DOUBLE-CHANNEL submersible pumps



Q = Flow rate H = Total manometric head

Tolerance of the performance curves according to EN ISO 9906 App. A.

TYPE		POWER		m³/h l/min	0	3	6	9	12	15	18	21	24	27	30	36	42	48
Single-phase	Three-phase	kW	HP		0	50	100	150	200	250	300	350	400	450	500	600	700	800
PATROL 10/45M	PATROL 10/45	0.75	1	H metres	12	10.7	9.7	8.7	7.8	6.8	5.9	5	4	3	2			
PATROL 15/45M	PATROL 15/45	1.1	1.5		15	14	13	12.3	11.5	10.5	9.7	8.8	8	7	6.2	4.5	2.7	1

DIMENSIONS AND WEIGHTS

TYPE		PORT DN	passage of solid bodies Ø 45 mm	DIMENSIONS mm												kg	
Single-phase	Three-phase			a	b	c	h	h1	m	n	o	d	e	p	∅	1~	3~
PATROL 10/45M	PATROL 10/45	2"	Ø 45 mm	110	90	150	375	148	81	200	66	55	adjust- able	500	500	19.9	18.3
PATROL 15/45M	PATROL 15/45			120	97	163	395	153								22.1	21.0





RANGE OF PERFORMANCE

Flow rate up to 800 l/min (48 m³/h)

Head up to 15 m

LIMITS OF USE

Depth up to 10 m

Liquid temperature up to + 40°C

Passage of suspended solid bodies up to
Ø 45 mm

For continuous duty: minimum immer-
sion 290 mm from pump base

INSTALLATION AND USE

THE PUMPS IN THE PATROL SERIES ARE MADE OF EXCEPTIONALLY ROBUST HEAVY-GAUGE CAST IRON, RESISTANT TO ABRASION AND LONG-LASTING. THEY ARE EQUIPPED WITH A DOUBLE-CHANNEL IMPELLER WHICH ALLOWS THE DRAINAGE OF LIQUIDS CONTAINING SUSPENDED SOLID BODIES WITH DIMENSIONS UP TO Ø 45 mm AND SHORT FIBRES. THEY ARE IDEAL FOR PUMPING DRAINAGE WATER AND SEWAGE, WASTE WATER INCLUDING WATER MIXED WITH MUD, GROUNDWATER AND SURFACE WATER IN APPLICATIONS SUCH AS: CONDOMINIUMS, MULTI-STORY AND UNDERGROUND CAR PARKS, WASHING AREAS AND INDUSTRY.

GUARANTEE 2 YEARS subject to our general terms of sale.

CONSTRUCTION CHARACTERISTICS

- **PUMP BODY:** cast iron, with threaded port ISO 228/1.
 - **MOTOR CASING AND BASE:** cast iron.
 - **IMPELLER:** double-channel, in stainless steel AISI 304.
 - **MOTOR SHAFT:** stainless steel EN 10088-3 - 1.4104.
 - **DOUBLE SEAL:** mechanical seal silicon carbide-ceramic-NBR, with oil barrier chamber and inner lip seal to protect the seal in the event of dry running.
 - **MOTOR:** submersible asynchronous for continuous duty.
- PATROL M:** single-phase 220÷240 V - 50 Hz with thermal overload protector.
- PATROL:** three-phase 380÷415 V - 50 Hz.
- **INSULATION:** class F.
 - **PROTECTION:** IP 68.

STANDARD FEATURES:

PATROL M (single-phase)

- Float switch.
- Neoprene power cable "H07 RN-F" length 10 metres with Schuko plug.
- Control box with condenser.

PATROL (three-phase)

- Neoprene power cable "H07 RN-F" length 10 metres.



OPTIONS ON REQUEST

- ⇒ control box for three-phase pumps 1.1 kW
- ⇒ single-phase pumps without float switch
- ⇒ other voltages or frequency 60 Hz

CONSTRUCTION AND SAFETY STANDARDS

EN 60034-1

IEC 34-1

CEI 2-3



DIMENSIONS

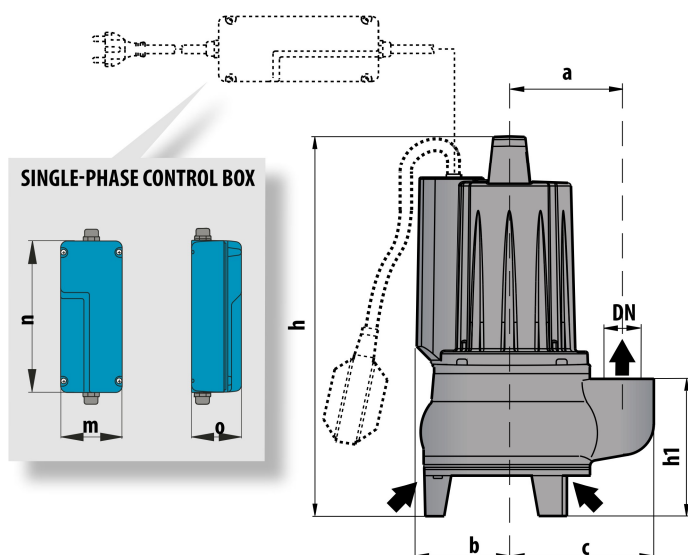

Typical installation

